

Cold applied metal connection kit

These connection kits are designed for terminating all Raychem BTV, QTVR, XTV, KTV and VPL industrial parallel heating cables to a junction box, whilst maintaining electrical insulation of the heating cable conductors and core. The braid is directly connected to the metal gland body. The connection kits

can be used with metal boxes or plastic boxes with internal earthing plate. They are approved for use in hazardous areas.

The core sealing boot does not require a heat gun or torch for the installation (no hot work permit necessary). The non-curing sealant (silicone free) allows easy

installation and facilitates maintenance purposes.

The C25-100-METAL kit is designed for use with M25 entries, the C3/4-100-METAL for 3/4" NPT entries. A metal locknut is provided for earth bonding in plastic junction boxes.

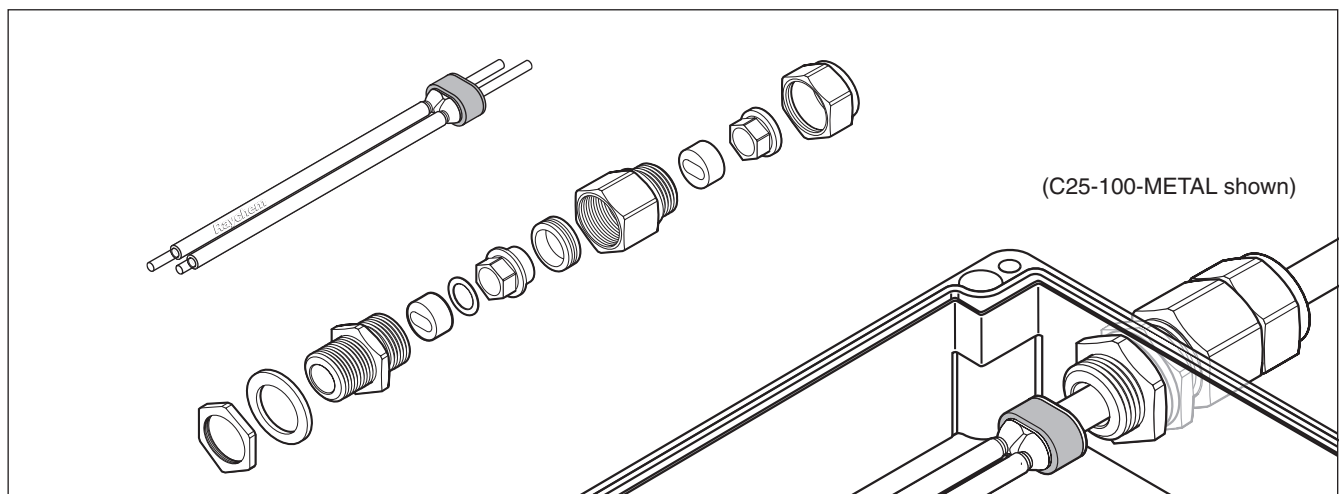

Application	Connection kit for BTV,QTVR, XTV, KTV and VPL parallel heating cables.
Kit contents	1 gland, 2 grommets, 1 locknut and sealing washer (only M25), 1 core sealer, 1 installation instruction (multilingual).
Approvals	Sira 01ATEX1270X  II 2 GD EEx d IIC / EEx e II (Ta = -60°C to +180°C) according to EN 50 014, EN 50 018, EN 50 019 (complete kit also referred in heating cable system approvals)

	C25-100-METAL	C3/4-100-METAL
Specification for gland		
Area classification	Hazardous Zone 1 and 2 (Gas), Zone 21 and 22 (Dust), ordinary In- and outdoors	Hazardous Zone 1 and 2 (Gas), Zone 21 and 22 (Dust), ordinary In- and outdoors
Thread size	M25 x 1.5	3/4" NPT
Gland material	Brass	Brass
Min. ambient temperature	-60°C	-60°C
Max. exposure temperature	180°C	180°C

Ordering details		
Part description	C25-100-METAL	C3/4-100-METAL
PN (Weight)	875016-000 (310 g)	440588-000 (304 g)

Also available in nickel plated brass		
Part description	C25-100-METAL-NP	C3/4-100-METAL-NP
PN (Weight)	1244-002296 (310 g)	1244-001350